

HYPRO® 9742P 2" Electric-Driven Poly Transfer Pumps

Versatile Pumps Ideal for Tank Filling and Chemical Transfer

The polypropylene pump body makes this product line ideal for use in transferring a variety of fluids including corrosive chemicals like Roundup® and Atrazine. Tank filling, chemical transfer & other stationary liquid transfer applications are just a few more of its many uses.

Features & Benefits

- Polypropylene housing is suitable for corrosive environments
- Easily handles high-capacity liquid transfer jobs with flow rates up to 188 gpm/ 72 lpm
- Self-priming capabilities with maximum suction lift up to 25 feet/7.62 meters
- Nylon impellers constructed for improved strength can handle solid particles in suspension up to 3/8" diameter
- EPDM mechanical seal and inlet valve for longevity and reliability in most applications
- Available with either 5 hp or 7.5 hp 50/60 hz TEFC Baldor electric motor
 - Three phase 230/460 volt motors in both 5 hp & 7.5 hp
 - Single phase 230 volt motor available in 5 hp
- Supported with one-year Hypro warranty on pump



Hypro's chemical-resistant, poly self-priming transfer pumps are ideal for rapid tank-filling, chemical transfer and other stationary liquid transfer.



Nylon impellers can handle solid particles in suspension up to 3/8" diameter.

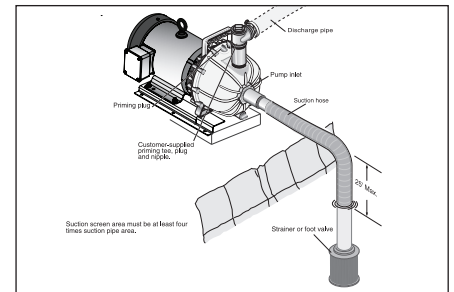

Self-priming capabilities with maximum suction lift up to 25 feet/7.62 meters.

HYPRO® 9742P 2" Electric-Driven Poly Transfer Pumps

Specifications

Pump Dimensions				
Dim.	9742P-050SPT3 9472P-075SPT3		9742P-050SP	
	Inch	mm	Inch	mm
A	13.6	346	13.16	346
B	6.4	162	6.4	162
C	12.2	311	12.2	311
D	6.7	171	6.7	171
E	23.7	602	25.2	640
F	5.7	144	5.7	144
G	6.7	170	6.7	170
H	6.7	170	6.7	170
I	10	255	10	255
J	5	128	5	128

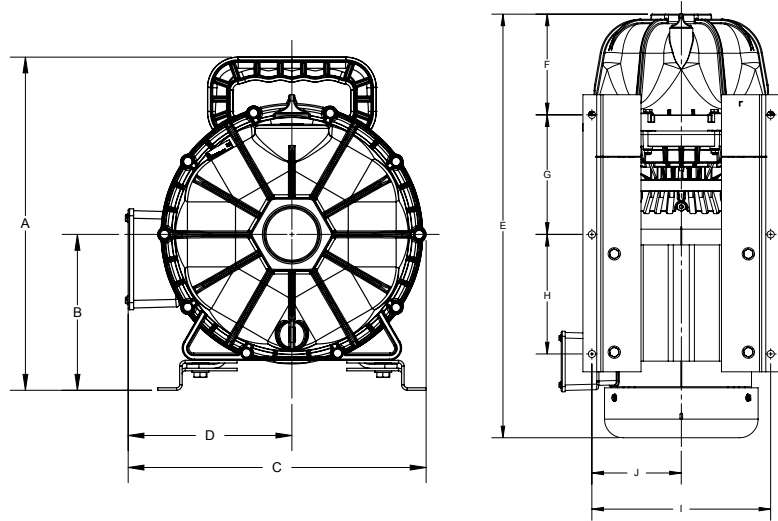

60 Hz

Pump	Max Flow Rate (GPM) [LPM]	Max Pressure (PSI) [BAR]	Ports	Dry Weight (LBS) [KG]	Mounting Bolts	Voltage (Volts)	Current (Amps)
9742P-050SPT	(150) [568]	(47) [3.2]	2" NPT Inlet & Outlet	(110) [50]	5/16" or M8	230	19.4
9742P-050SPT3	(150) [568]	(47) [3.2]		(90) [41]		230/460	12/6
9742P-075SPT3	(188) [712]	(54) [3.7]		(90) [41]		230/460	17.4/8.7

50 Hz

Pump	Max Flow Rate (GPM) [LPM]	Max Pressure (PSI) [BAR]	Ports	Dry Weight (LBS) [KG]	Mounting Bolts	Voltage (Volts)	Current (Amps)
9742P-050SPT	(120) [454]	(32) [2.2]	2" NPT Inlet & Outlet	(110) [50]	5/16" or M8	220	14
9742P-050SPT3	(120) [454]	(32) [2.2]		(90) [41]		190/380	11.4/5.7
9742P-075SPT3	(160) [606]	(37) [2.6]		(90) [41]		190/380	14.4/7.2

Performance

9742P-050SPT & 9742P-050SPT3

US

60 Hz	PSI	0	5	10	15	20	25	30	35	40	45	47
	GPM	150	142	133	123	111	97	84	66	43	9	0
50 Hz	PSI	0	5	10	15	20	25	30	32	-	-	-
	GPM	120	110	100	85	67	42	10	0	-	-	-

9742P-050SPT & 9742P-050SPT3

Metric

60 Hz	BAR	0	0.3	0.7	1	1.4	1.7	2.1	2.4	2.8	3.1	3.2
	LPM	568	538	503	466	420	367	318	250	163	34	0
50 Hz	BAR	0	0.3	0.7	1	1.4	1.7	2.1	2.2	-	-	-
	LPM	454	416	379	322	254	159	38	0	-	-	-

9742P-075SPT3

US

60 Hz	PSI	0	5	10	15	20	25	30	35	40	45	50	54
	GPM	188	185	181	173	163	151	136	120	102	76	44	0
50 Hz	PSI	0	5	10	15	20	25	30	35	37	-	-	-
	GPM	160	155	143	129	112	90	65	20	0	-	-	-

9742P-075SPT3

Metric

60 Hz	BAR	0	0.3	0.7	1	1.4	1.7	2.1	2.4	2.8	3.1	3.4	3.7
	LPM	712	700	685	655	617	572	515	454	386	288	167	0
50 Hz	BAR	0	0.3	0.7	1	1.4	1.7	2.1	2.4	2.6	-	-	-
	LPM	606	587	541	488	424	341	246	76	0	-	-	-



375 5TH AVE NW, NEW BRIGHTON, MN 55112 WWW.HYPROPUMPS.COM
 PH: 800-424-9776 ORDERS FAX: 800-323-6496
 Because we are continuously improving our products and services,
 Pentair reserves the right to change specifications without prior notice.

