

HYPRO® 9742P 2" Electric-Driven Poly Transfer Pumps

Versatile Pumps Ideal for Tank Filling and Chemical Transfer

The polypropylene pump body makes this product line ideal for use in transferring a variety of fluids including corrosive chemicals like Roundup® and Atrazine. Tank filling, chemical transfer & other stationary liquid transfer applications are just a few more of its many uses.

Features & Benefits

- Polypropylene housing is suitable for corrosive environments
- Easily handles high-capacity liquid transfer jobs with flow rates up to 188 gpm/ 72 lpm
- Self-priming capabilities with maximum suction lift up to 25 feet/7.62 meters
- Nylon impellers constructed for improved strength can handle solid particles in suspension up to 3/8" diameter
- EPDM mechanical seal and inlet valve for longevity and reliability in most applications
- Available with either 5 hp or 7.5 hp 50/60 hz TEFC Baldor electric motor
 - Three phase 230/460 volt motors in both 5 hp & 7.5 hp
 - Single phase 230 volt motor available in 5 hp
- Supported with one-year Hypro warranty on pump



Hypro's chemical-resistant, poly self-priming transfer pumps are ideal for rapid tank-filling, chemical transfer and other stationary liquid transfer.



Nylon impellers can handle solid particles in suspension up to 3/8" diameter.

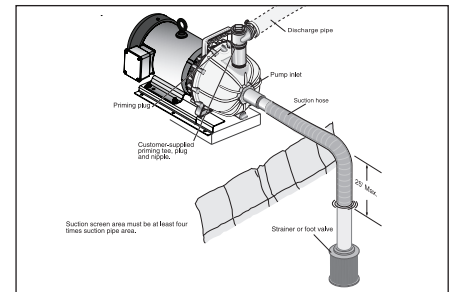

Self-priming capabilities with maximum suction lift up to 25 feet/7.62 meters.

HYPRO® 9742P 2" Electric-Driven Poly Transfer Pumps

Specifications

| Pump Dimensions | | | | |
|-----------------|--------------------------------|-----|-------------|-----|
| Dim. | 9742P-050SPT3 9472P-075SPT3 | | 9742P-050SP | |
| | Inch | mm | Inch | mm |
| A | 13.6 | 346 | 13.16 | 346 |
| B | 6.4 | 162 | 6.4 | 162 |
| C | 12.2 | 311 | 12.2 | 311 |
| D | 6.7 | 171 | 6.7 | 171 |
| E | 23.7 | 602 | 25.2 | 640 |
| F | 5.7 | 144 | 5.7 | 144 |
| G | 6.7 | 170 | 6.7 | 170 |
| H | 6.7 | 170 | 6.7 | 170 |
| I | 10 | 255 | 10 | 255 |
| J | 5 | 128 | 5 | 128 |

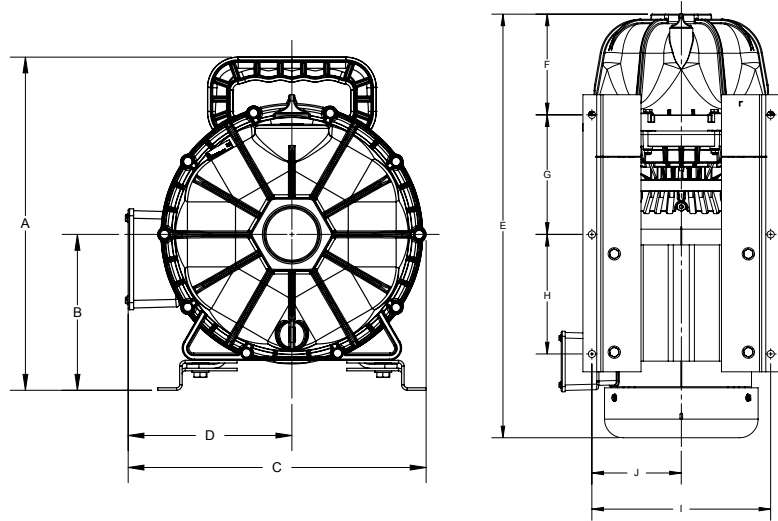

60 Hz

| Pump | Max Flow Rate (GPM) [LPM] | Max Pressure (PSI) [BAR] | Ports | Dry Weight (LBS) [KG] | Mounting Bolts | Voltage (Volts) | Current (Amps) |
|---------------|---------------------------|--------------------------|-----------------------|-----------------------|----------------|-----------------|----------------|
| 9742P-050SPT | (150) [568] | (47) [3.2] | 2" NPT Inlet & Outlet | (110) [50] | 5/16" or M8 | 230 | 19.4 |
| 9742P-050SPT3 | (150) [568] | (47) [3.2] | | (90) [41] | | 230/460 | 12/6 |
| 9742P-075SPT3 | (188) [712] | (54) [3.7] | | (90) [41] | | 230/460 | 17.4/8.7 |

50 Hz

| Pump | Max Flow Rate (GPM) [LPM] | Max Pressure (PSI) [BAR] | Ports | Dry Weight (LBS) [KG] | Mounting Bolts | Voltage (Volts) | Current (Amps) |
|---------------|---------------------------|--------------------------|-----------------------|-----------------------|----------------|-----------------|----------------|
| 9742P-050SPT | (120) [454] | (32) [2.2] | 2" NPT Inlet & Outlet | (110) [50] | 5/16" or M8 | 220 | 14 |
| 9742P-050SPT3 | (120) [454] | (32) [2.2] | | (90) [41] | | 190/380 | 11.4/5.7 |
| 9742P-075SPT3 | (160) [606] | (37) [2.6] | | (90) [41] | | 190/380 | 14.4/7.2 |

Performance

9742P-050SPT & 9742P-050SPT3

US

| 60 Hz | PSI | 0 | 5 | 10 | 15 | 20 | 25 | 30 | 35 | 40 | 45 | 47 |
|-------|-----|-----|-----|-----|-----|-----|----|----|----|----|----|----|
| | GPM | 150 | 142 | 133 | 123 | 111 | 97 | 84 | 66 | 43 | 9 | 0 |
| 50 Hz | PSI | 0 | 5 | 10 | 15 | 20 | 25 | 30 | 32 | - | - | - |
| | GPM | 120 | 110 | 100 | 85 | 67 | 42 | 10 | 0 | - | - | - |

9742P-050SPT & 9742P-050SPT3

Metric

| 60 Hz | BAR | 0 | 0.3 | 0.7 | 1 | 1.4 | 1.7 | 2.1 | 2.4 | 2.8 | 3.1 | 3.2 |
|-------|-----|-----|-----|-----|-----|-----|-----|-----|-----|-----|-----|-----|
| | LPM | 568 | 538 | 503 | 466 | 420 | 367 | 318 | 250 | 163 | 34 | 0 |
| 50 Hz | BAR | 0 | 0.3 | 0.7 | 1 | 1.4 | 1.7 | 2.1 | 2.2 | - | - | - |
| | LPM | 454 | 416 | 379 | 322 | 254 | 159 | 38 | 0 | - | - | - |

9742P-075SPT3

US

| 60 Hz | PSI | 0 | 5 | 10 | 15 | 20 | 25 | 30 | 35 | 40 | 45 | 50 | 54 |
|-------|-----|-----|-----|-----|-----|-----|-----|-----|-----|-----|----|----|----|
| | GPM | 188 | 185 | 181 | 173 | 163 | 151 | 136 | 120 | 102 | 76 | 44 | 0 |
| 50 Hz | PSI | 0 | 5 | 10 | 15 | 20 | 25 | 30 | 35 | 37 | - | - | - |
| | GPM | 160 | 155 | 143 | 129 | 112 | 90 | 65 | 20 | 0 | - | - | - |

9742P-075SPT3

Metric

| 60 Hz | BAR | 0 | 0.3 | 0.7 | 1 | 1.4 | 1.7 | 2.1 | 2.4 | 2.8 | 3.1 | 3.4 | 3.7 |
|-------|-----|-----|-----|-----|-----|-----|-----|-----|-----|-----|-----|-----|-----|
| | LPM | 712 | 700 | 685 | 655 | 617 | 572 | 515 | 454 | 386 | 288 | 167 | 0 |
| 50 Hz | BAR | 0 | 0.3 | 0.7 | 1 | 1.4 | 1.7 | 2.1 | 2.4 | 2.6 | - | - | - |
| | LPM | 606 | 587 | 541 | 488 | 424 | 341 | 246 | 76 | 0 | - | - | - |



375 5TH AVE NW, NEW BRIGHTON, MN 55112 WWW.HYPROPUMPS.COM
 PH: 800-424-9776 ORDERS FAX: 800-323-6496
 Because we are continuously improving our products and services,
 Pentair reserves the right to change specifications without prior notice.

